

FINAL PLAT
THE BLUFFS OF CARTECAY
 L.L. 95, 96 AND 121, 11th DIST., 1st SEC.
 GILMER COUNTY, GEORGIA

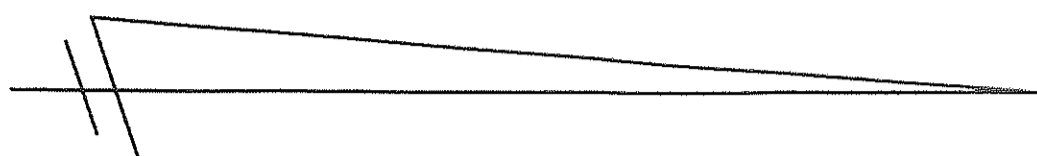

INDEX MAP

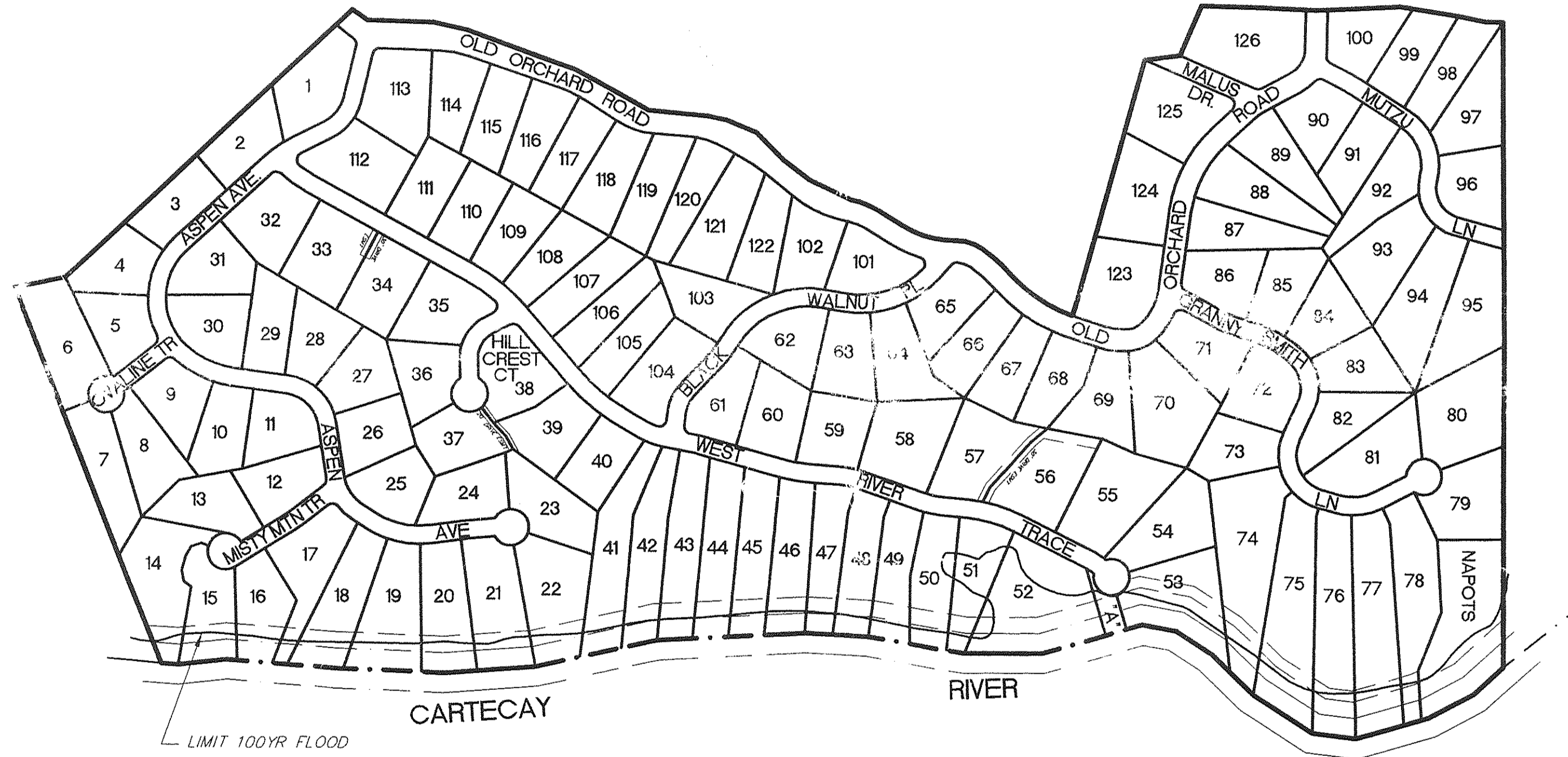

- PLAT SHEET 3.....LOTS 1-3; 32-34; 111-113
- PLAT SHEET 4.....LOTS 4-18; 28-31
- PLAT SHEET 5.....LOTS 19-28; 35-39
- PLAT SHEET 6.....LOTS 40-47; 59-61; 104-106
- PLAT SHEET 7.....LOTS 48-51; 56-58; 62-67; 101-102
- PLAT SHEET 8.....LOTS 52-56; 68-70; 123
- PLAT SHEET 9.....LOTS 72-85
- PLAT SHEET 10.....LOTS 88-100
- PLAT SHEET 11.....LOTS 68-71; 86-87; 123-126
- PLAT SHEET 12.....LOTS 107-110; 114-122

Filed in office Clerk of Superior Court
 Gilmer County, Georgia, at 4:00 P. M.
 Date: OCTOBER 2, 2002
 Recorded Plat Book 39 Page 90
Glenda Sue Johnson
 Glenda Sue Johnson, Clerk

